

Refer to Diagram 6 below. Using five **A/G/F** strips and four **A/D/G** hourglass units, **pin** the pieces together side by side as shown below making sure all the cream print is on the bottom and all the green ditsy is on the top. Shorten your stitch length and sew the units together pressing seams open. Repeat with another five **A/G/F** strips and the four remaining **A/D/G** hourglass units. Label these “Left and Right Outer Sashing Strips” and set aside for now. Save the eight remaining **A/G/F** strips for the Top and Bottom Outer Sashing Strips.



Diagram 6

From **Fabric A**, cut (2) 3” x 3” squares. From **Fabric G**, cut (2) 3” x 3” squares, and (3) 2⁵/₈” x 2⁵/₈” squares.

Using one **Fabric A** square and one 3” **Fabric G** square, follow steps 1-5 as shown on the top of this page. You will now have 4 **A/G** triangle units. Repeat these steps with the remaining **Fabric A** square and 3” **Fabric G** square to make 4 additional **A/G** triangle units. You will now have a total of 8 **A/G** triangle units. You will only be using 6 of these units; remove the extra 2 units from your workspace to avoid confusion.

With each 2⁵/₈” **Fabric G** square, cut **ONCE** on the diagonal to yield 2 red triangles. Place one **A/G** triangle unit and one red triangle RST and sew together along the long diagonal. Open and press as you prefer. We will now refer to this as an **A/G/G** unit. Repeat to make a total of 6 **A/G/G** units. Refer to Step 9 above to square up your **A/G/G** units to 2” x 2”.

Refer to Diagram 7 below. Take 4 of the longer **A/G/F** strips you previously saved and 3 of the **A/G/G** units. Orient them as shown in Diagram 7. Shorten your stitch length and sew the units together pressing seams open. Repeat with the 4 remaining **A/G/F** strips and the 3 **A/G/G** units to make a second row. These are your Top and Bottom Outer Sashing Strips.



Diagram 7

From Fabric A, cut (2) 2½” squares. From Fabric G, cut (2) 2½” squares. Refer to Steps 1-5 as shown below.

Step 1: On the back of each **Fabric A** square, draw a line diagonally from corner to corner. Step 2: Layer a **Fabric A** square and a **Fabric G** square with right sides together, making sure to line up the edges. Step 3: Shorten your stitch length and sew ¼” on either side of the drawn line. Step 4: Place the unit on your cutting mat and cut along the drawn line. Step 5: Open and press all seams toward the darker fabric. You should now have two half-square triangle units. Trim to exactly 2” x 2”. Repeat with the remaining squares of each color to yield a total of 4 **A/G** half-square triangle units.

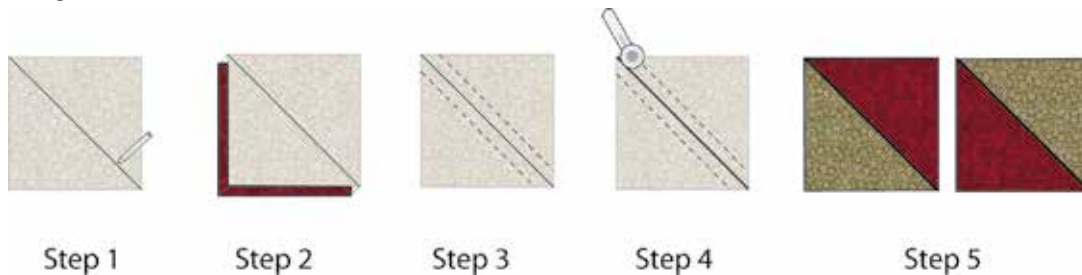

Refer to Diagram 8 below. Take the Left and Right Outer Sashing strips and carefully pin them to the left and right sides of the quilt, **making sure to pin the intersections first**. Adjust the seams as necessary to make sure the **A/D/G** hourglass units are perfectly lined up with the horizontal sashing strips. Sew the Left and Right Outer Sashing strips to the quilt. Press seams open. Take the four **A/G** half-square triangles and sew one to each end of the Top and Bottom Outer Sashing strips as shown below. Take the Top and Bottom Sashing strips and carefully pin them to the top and bottom of the quilt, **making sure to pin the intersections first**. Adjust the seams as necessary to make sure the **A/G/G** units are perfectly lined up with the vertical sashing strips. Sew the Top and Bottom Outer Sashing strips to the quilt. Press seams open.

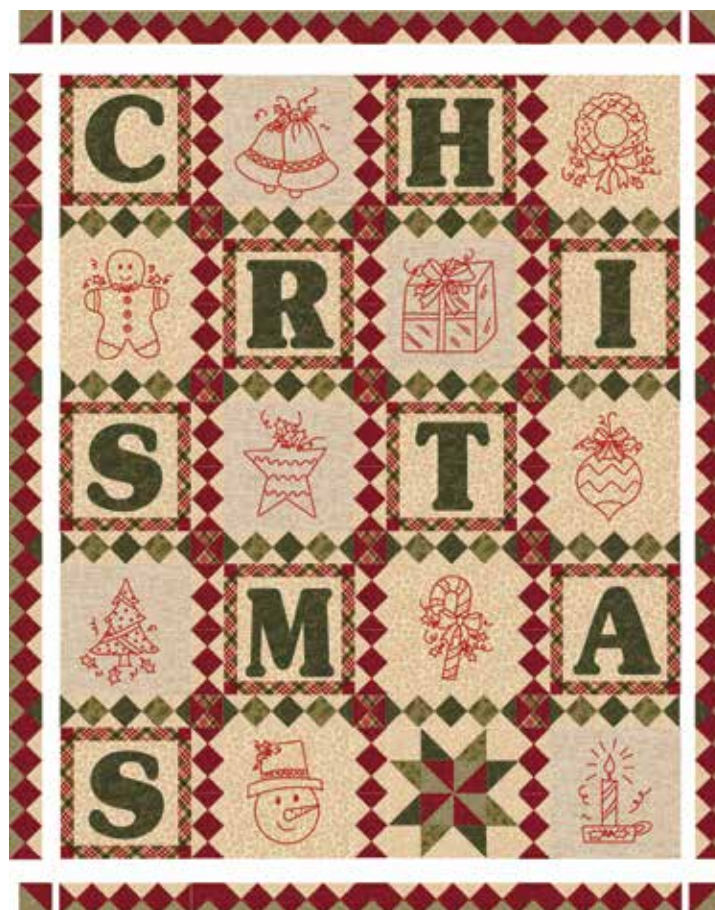

Diagram 8